

A Tree Planting

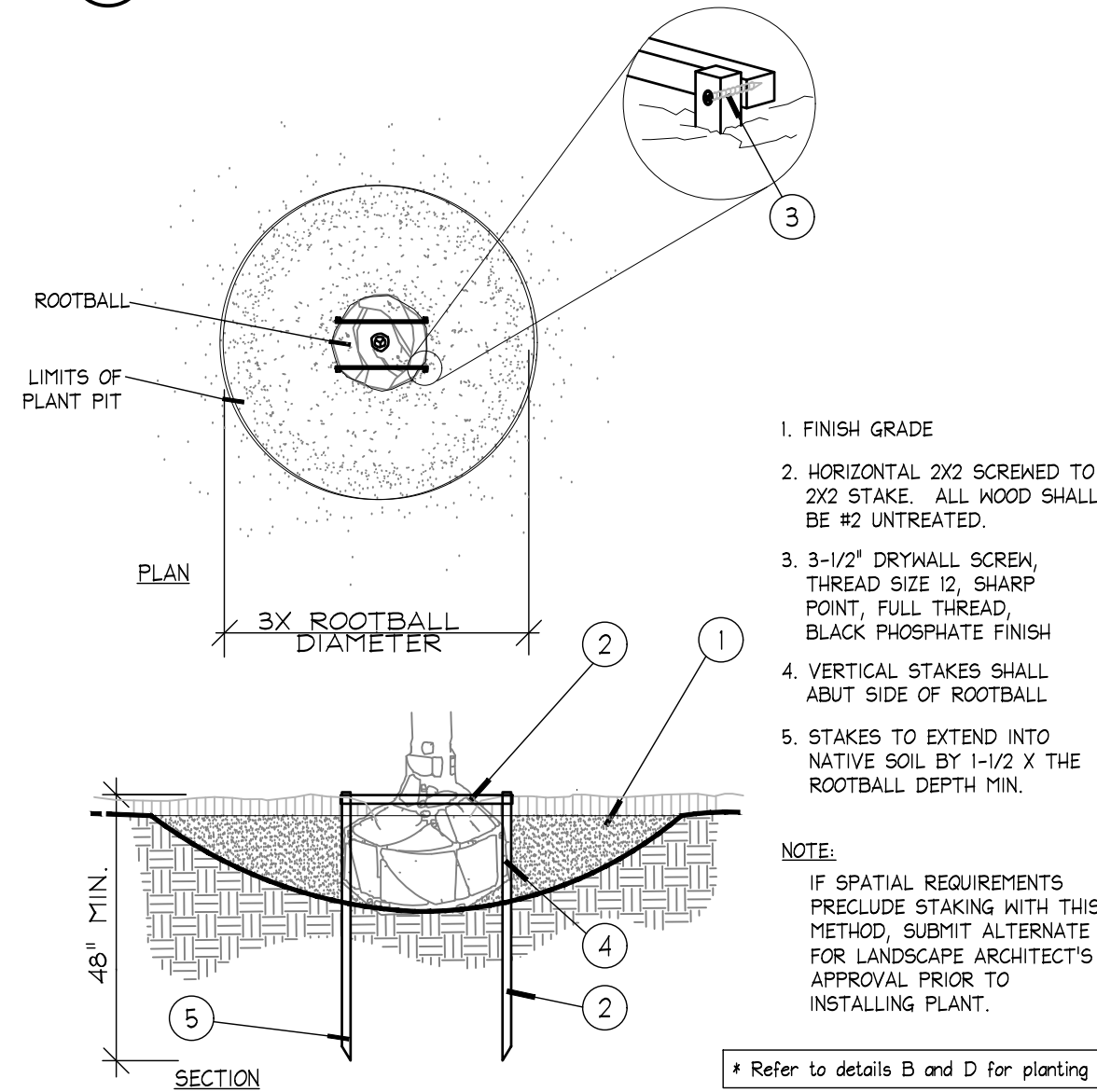

(F) Staking - up to 65 gal. or B&B to 3-1/2" Cal.

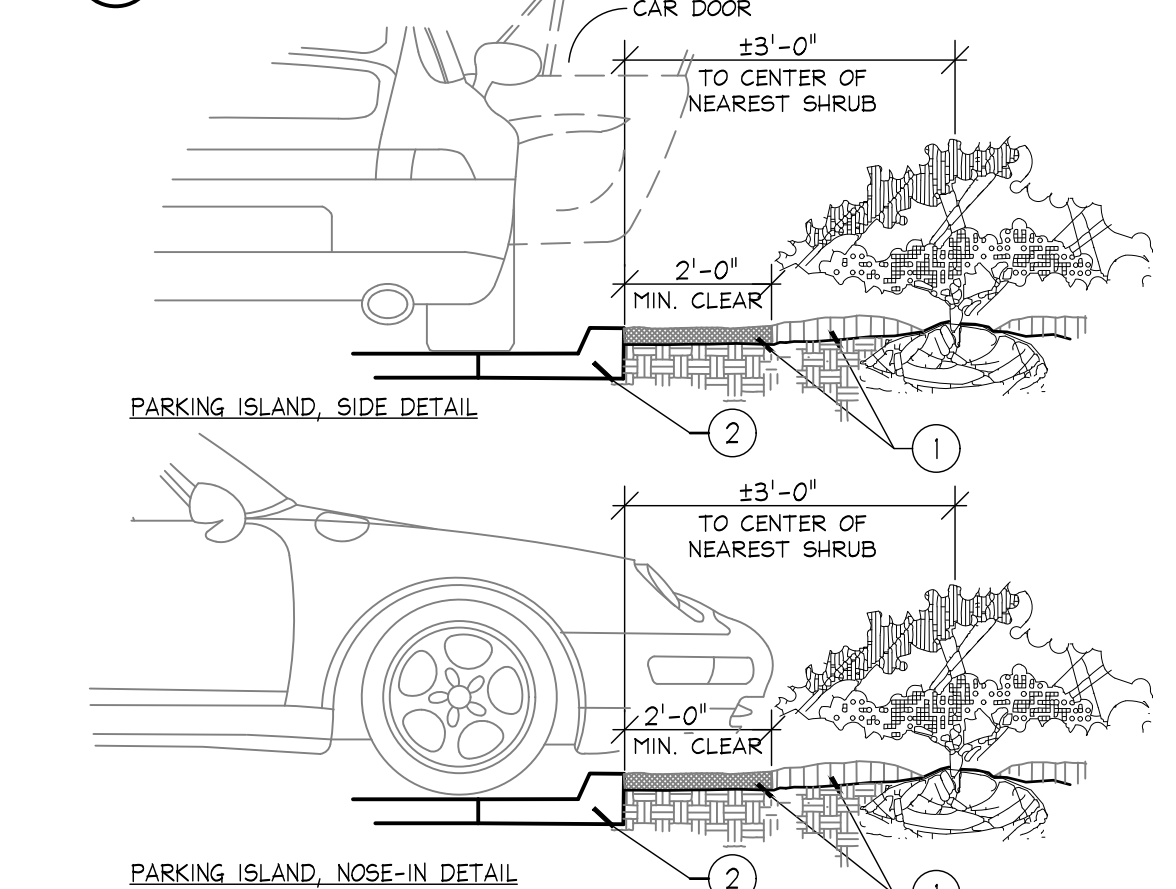

1. INSTALL CONTINUOUS MULCH BED ADJACENT TO PARKING SPACES AS SHOWN. MULCH SHALL BE MIN. 3" DEEP.
NO POP-UP IRRIGATION HEADS SHALL BE LOCATED WITHIN 24" OF A PARKING SPACE ON ANY SIDE
2. CURB OR PARKING LOT EDGE, BY OTHERS

J Parking Space/Curb Planting

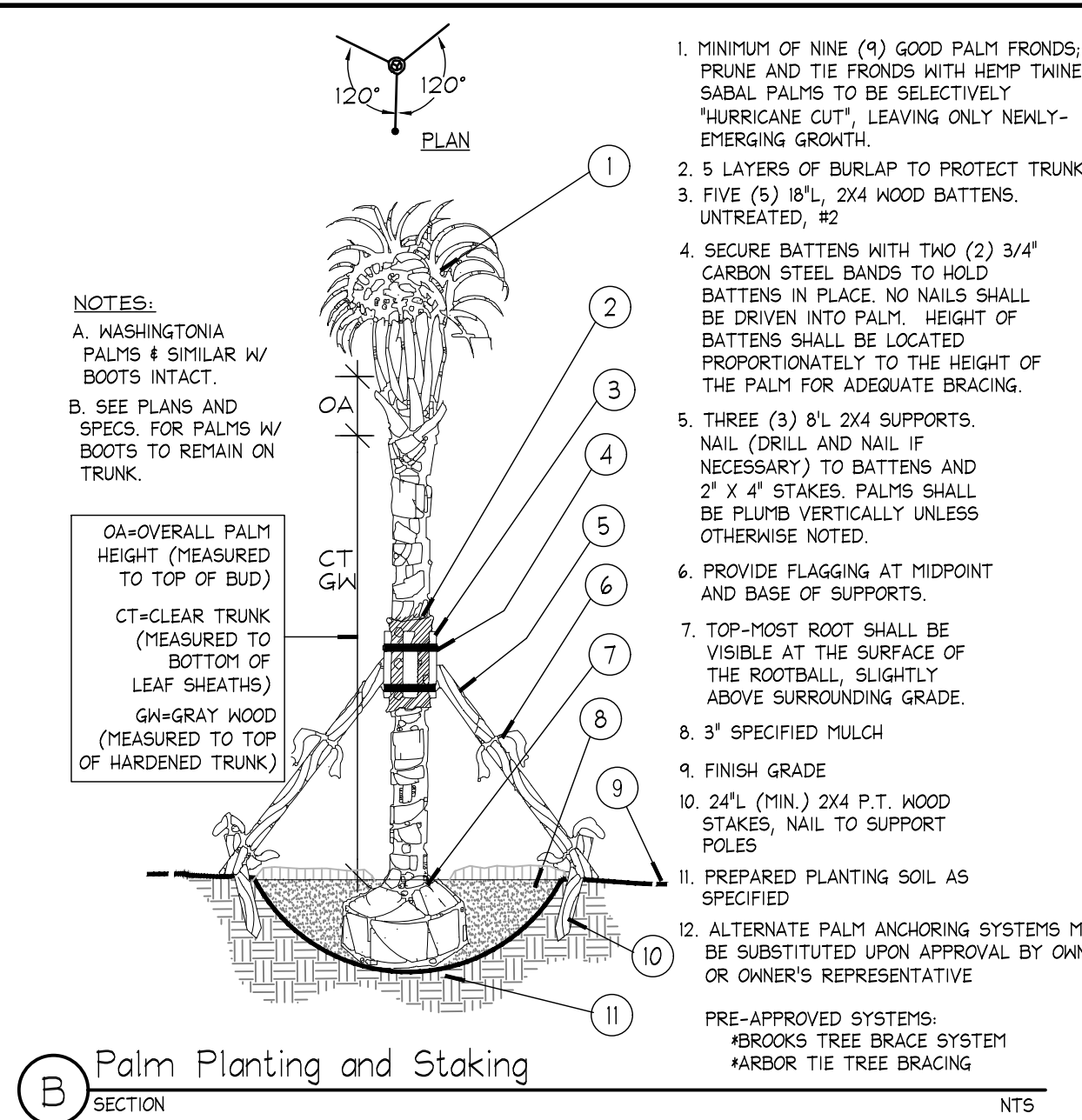

B
 Palm Planting and Staking

 *BROOKS TREE BRACE SYSTEM
 *ARBOR TIE TREE BRACING

SECTION
 NTS

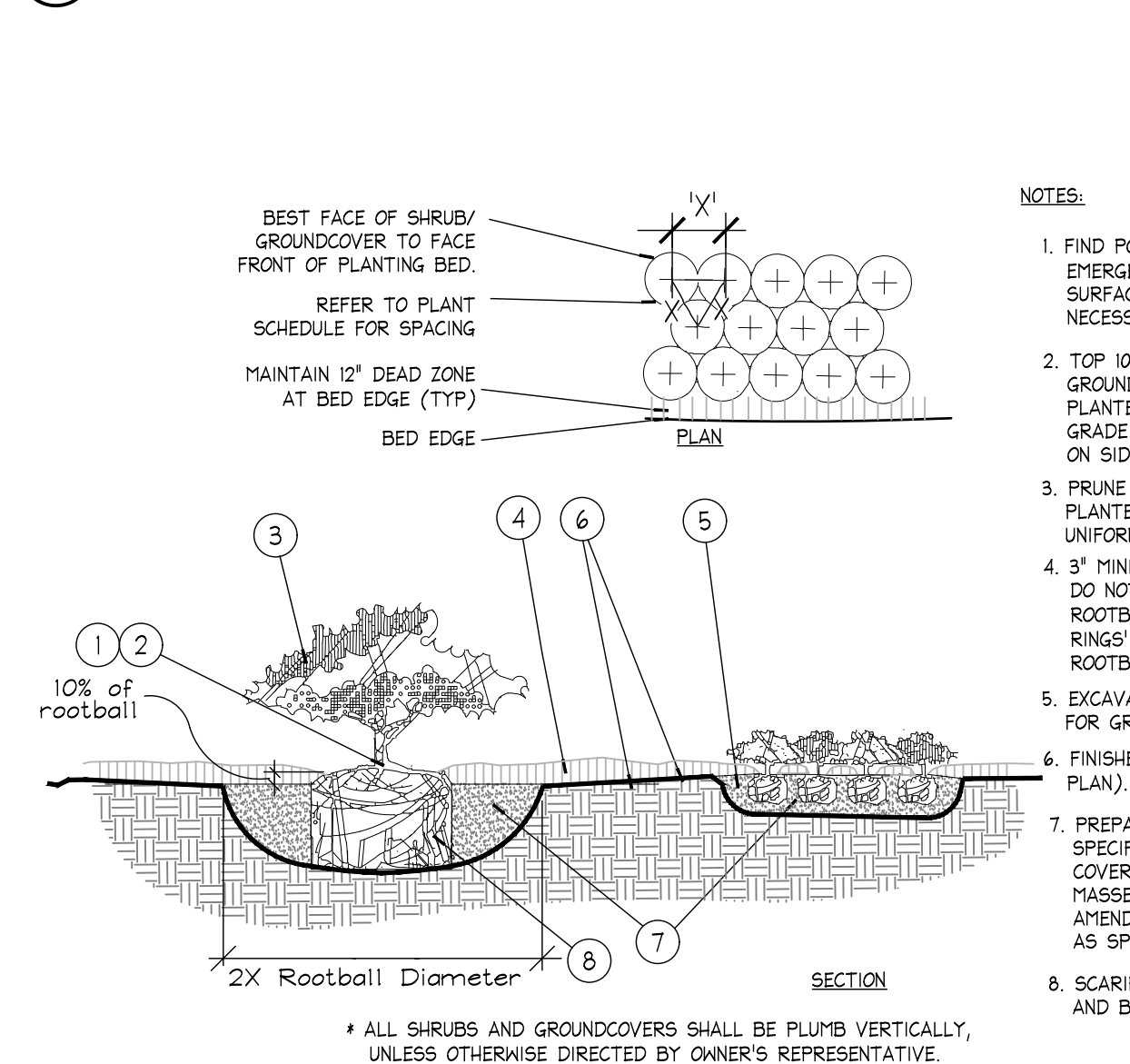

Shrub / Groundcover Planting

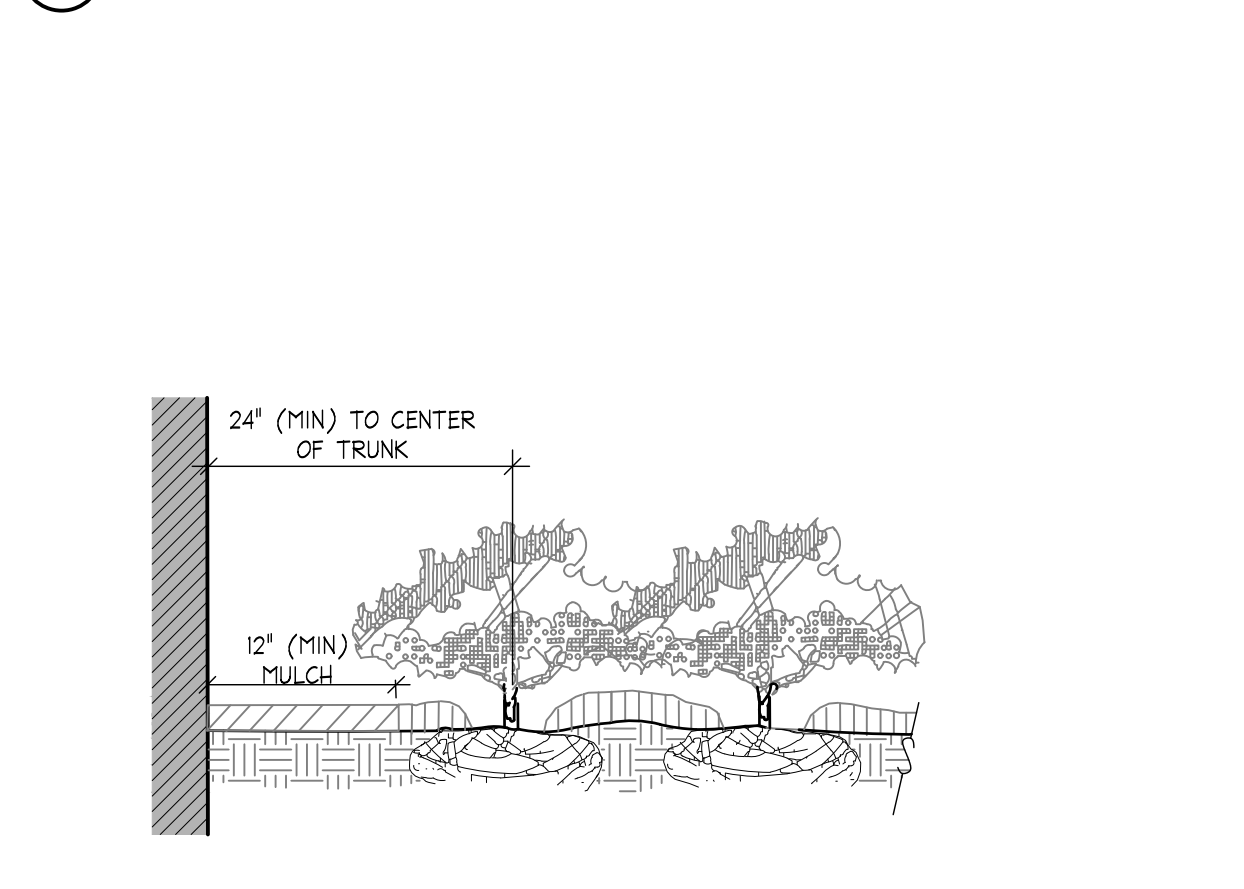

- NOTES
- * CLEAR ZONE: 24" MIN. FROM BUILDING TO CENTER OF NEAREST SHRUB

K Plantings Adjacent to Buildings

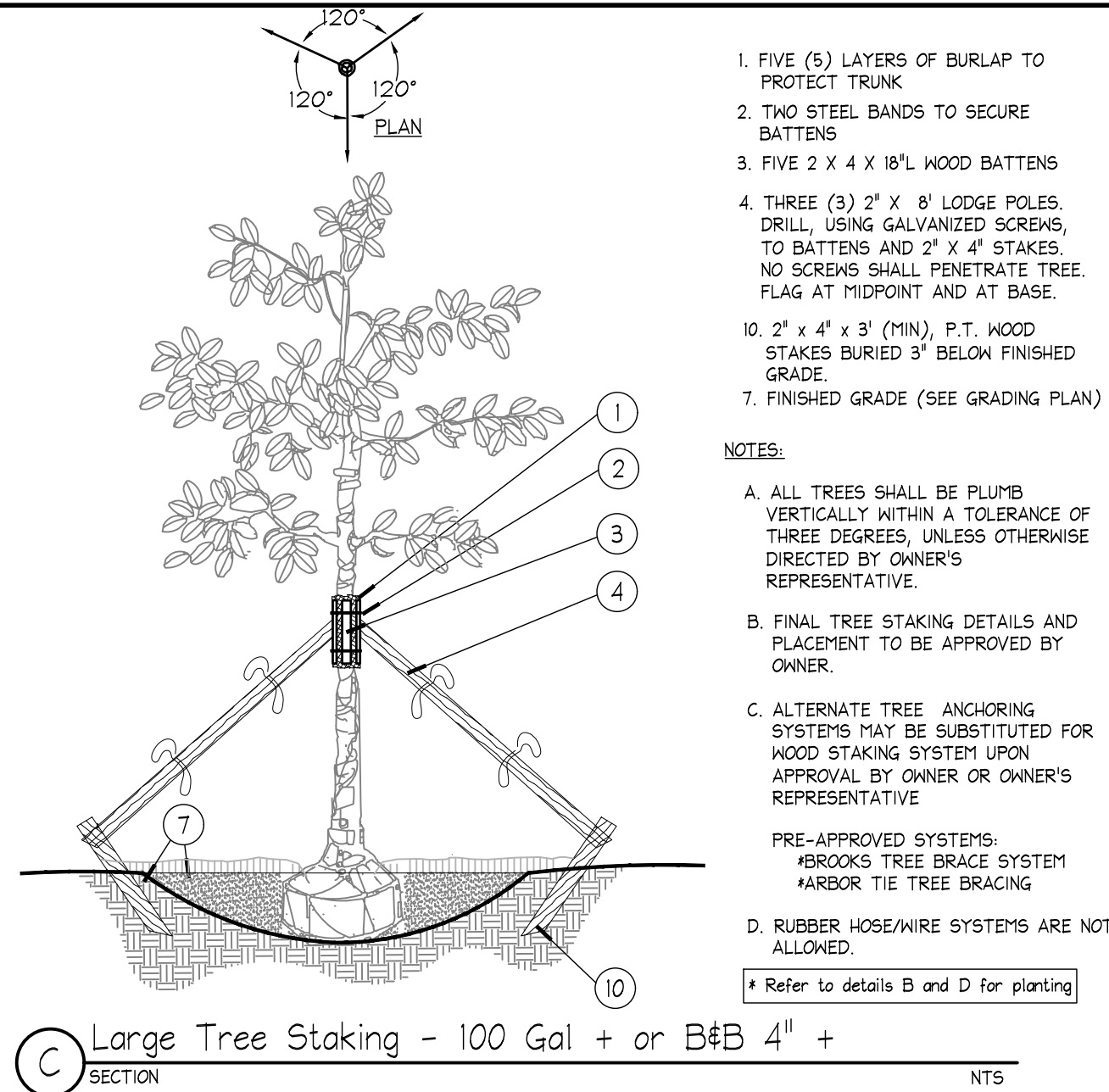

(C) Large Tree Staking - 100 Gal + or B&B 4" +

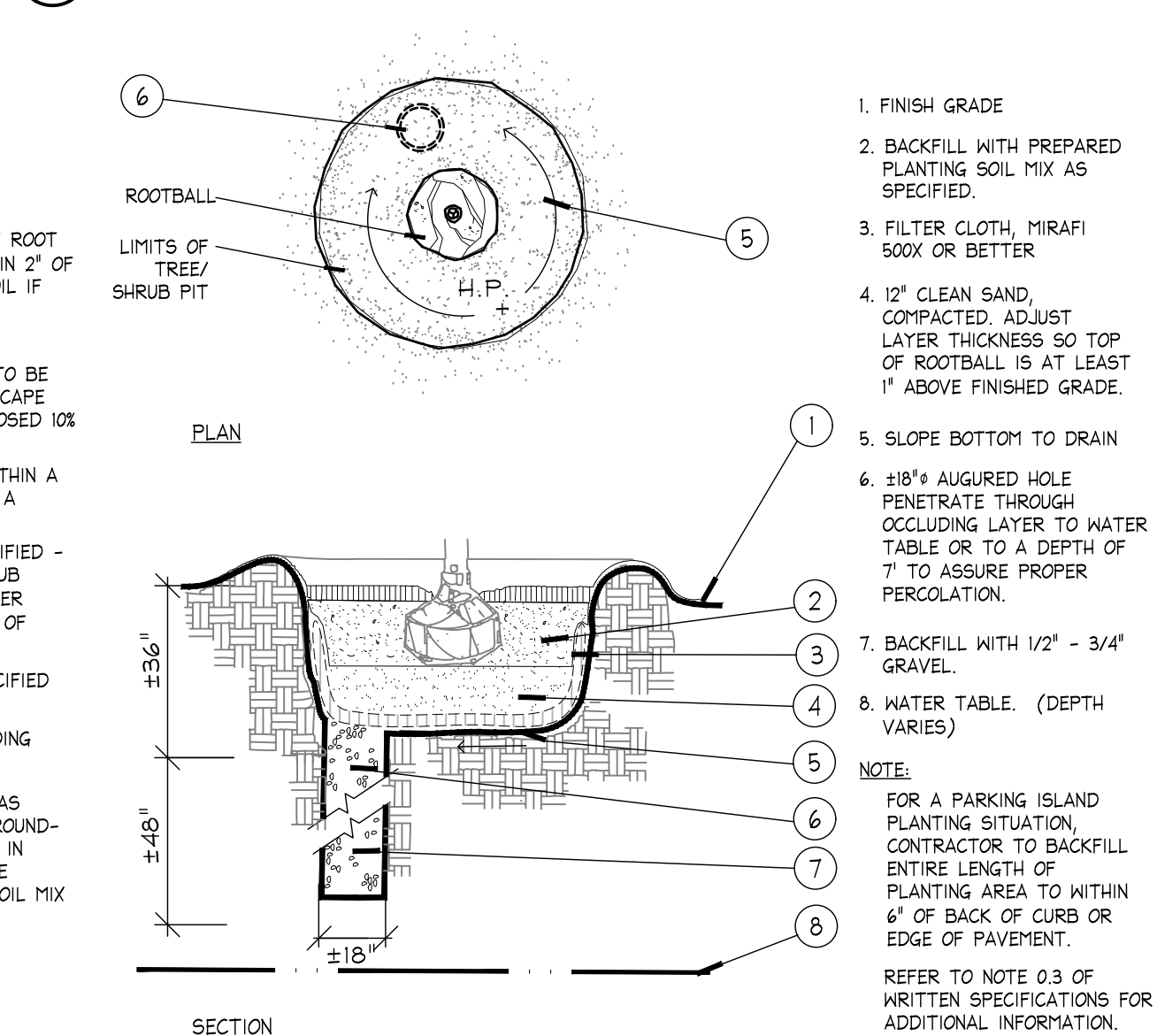

H

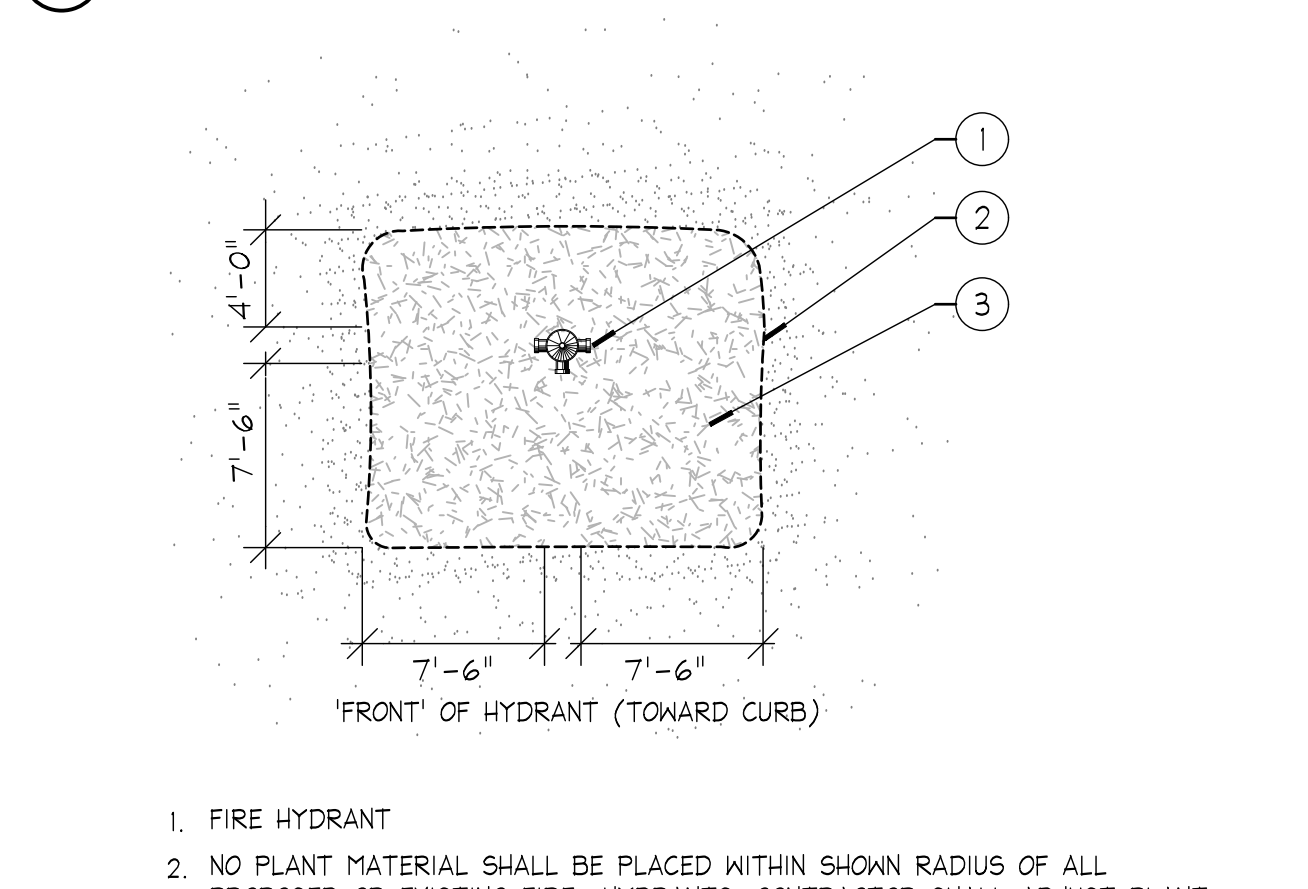

1. FIRE HYDRANT
2. NO PLANT MATERIAL SHALL BE PLACED WITHIN SHOWN RADIUS OF ALL PROPOSED OR EXISTING FIRE HYDRANTS. CONTRACTOR SHALL ADJUST PLANT MATERIAL SO THAT NO CONFLICTS WITH FIRE HYDRANTS OCCUR ON SITE.
3. PROVIDE A MULCH, 3" DEPTH MIN., SURROUNDING AREA INDICATED.

Fire Hydrant Clear Zone

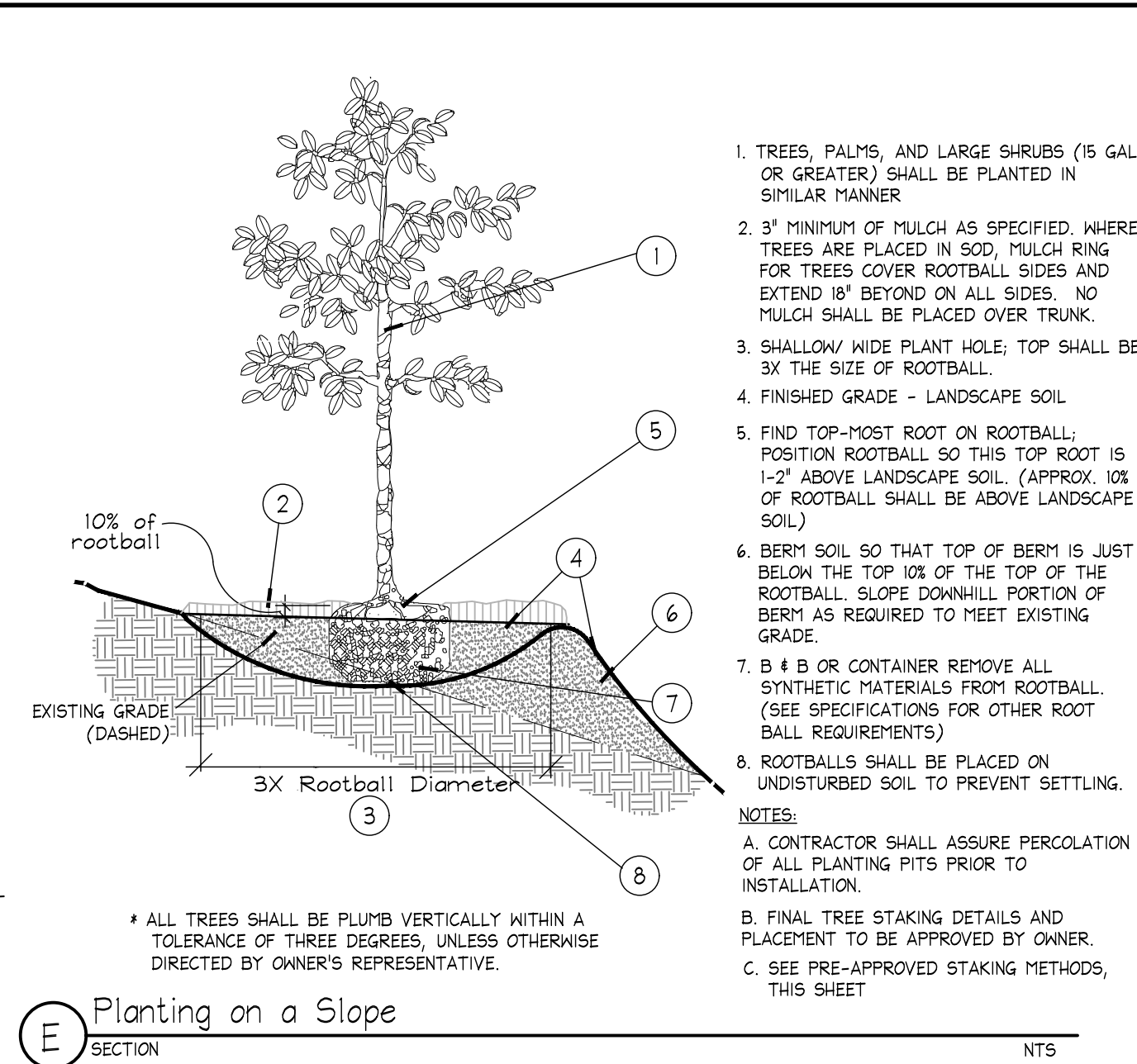

E
 Planting on a Slope
 THIS SHEET

E
 SECTION
 NTS

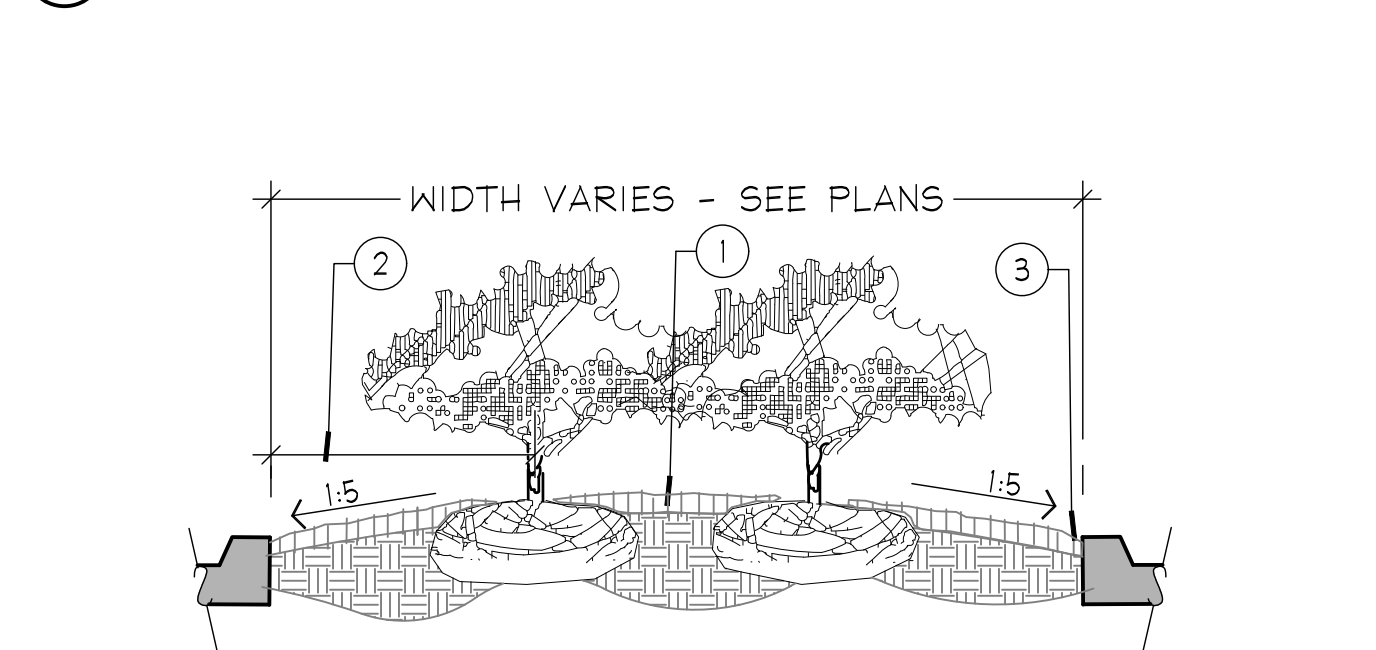
PLANTER ISLAND NOTES

1. CROWN ISLANDS @ 5:1 SLOPES (OR AS SPECIFIED ON THE LANDSCAPE PLANS).
2. CLEAR ZONE: 36" MIN. FROM BACK OF CURB TO CENTER OF NEAREST SHRUB.
CLEAR ZONE SHALL CONTAIN 3" CONTINUOUS MULCH OR TURF, SEE PLANS. SEE
DETAIL '1' FOR PLANTER MEDIANS ADJACENT TO PARKING SPACES.
3. 1" MIN VERTICAL CLEARANCE, TOP OF CURB TO TOP OF MULCH.

- EXCAVATE CONTINUOUS 36" DEEP (FROM TOP OF CURB) FOR ENTIRE LENGTH AND WIDTH OF ISLAND & BACKFILL WITH APPROVED PLANTING MIX.
- PROTECT AND RETAIN ALL CURBS AND BASE. COMPACTED SUBGRADE TO REMAIN FOR STRUCTURAL SUPPORT OF CURB SYSTEM (TYP).
- ALL ISLANDS SHALL UTILIZE POOR DRAINAGE DETAIL WHEN PERCOLATION RATES ARE 2" PER HOUR OR LESS.

Planted Parking Lot Islands / Medians

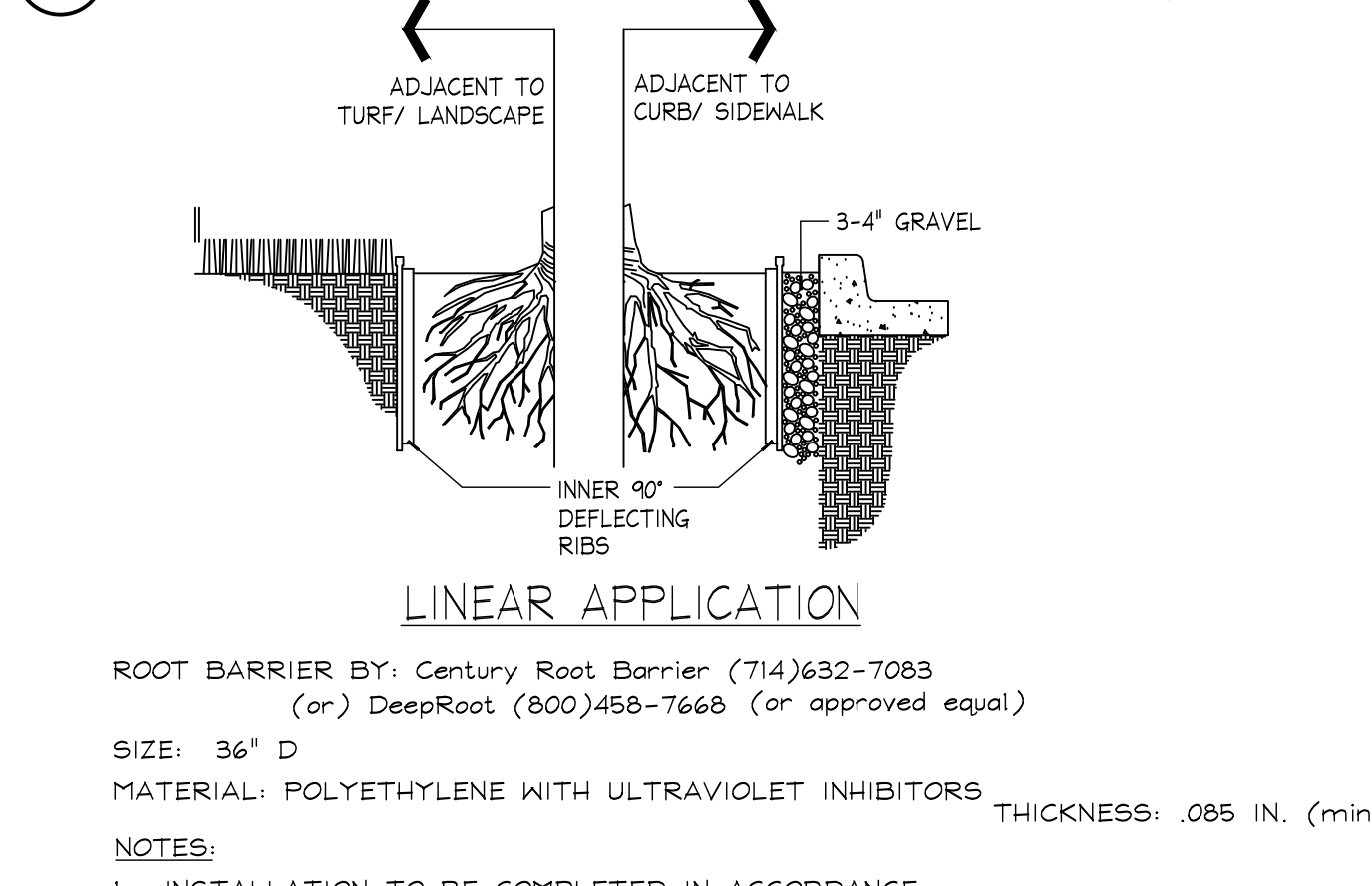

1. INSTALLATION TO BE COMPLETED IN ACCORDANCE WITH MANUFACTURER'S SPECIFICATIONS.
2. INSTALL AS REQUIRED, PER PLAN NOTES.
3. SUBMIT PRODUCT DATA FOR APPROVAL.

Root Barrier

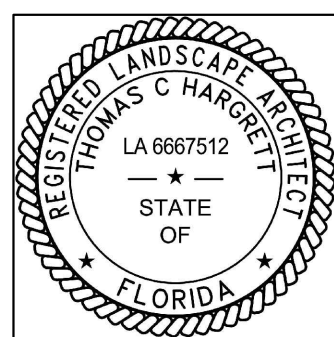

THE ITEM HAS BEEN DIGITALLY SIGNED AND SEALED BY TOM
HARGRETT ON THE DATE ADJACENT TO THE SEAL.

PRINTED COPIES OF THIS DOCUMENT ARE NOT CONSIDERED
SIGNED AND SEALED AND THE SIGNATURE MUST BE VERIFIED
ON ANY ELECTRONIC COPIES.

PLANS ARE IN NAVD 1988 DATUM
CONVERSION EQUATION IS BELOW:
(NAVD 1988) + 1.58' = (NGVD 1929)

THE PRESENCE OF GROUNDWATER SHOULD BE ANTICIPATED. CONTRACTOR'S BID SHALL INCLUDE CONSIDERATION FOR ADDRESSING THIS ISSUE AND OBTAINING ALL NECESSARY PERMITS

Always call 811 two full business days before you dig to have underground utilities located and marked.

Sunshine811.com